

Transmitter Radio Control Pairing Quick Start Guide

Step 1: Enter pairing mode

Press "Remote/Set" to power on remote then left and right arrows simultaneously to enter pairing mode and select "Pairing mode" in menu.

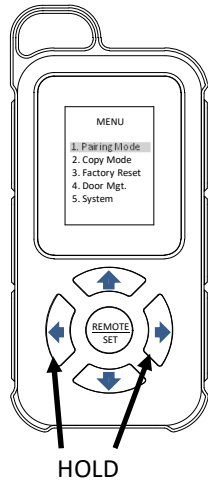

Step 2: Pairing Mode

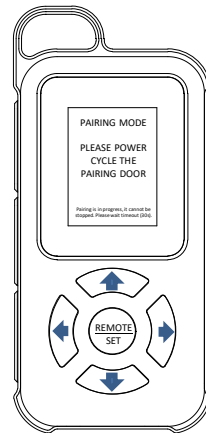

Step 3: Power OFF then power ON motor

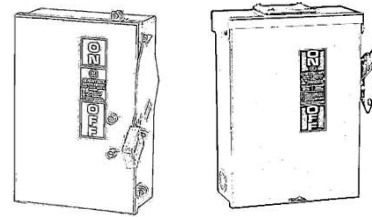

On the motor, once in pairing mode, cycle power off then on.

Step 4: Pairing Mode

Once power has been restored to motor, a "Receiver was found" notification will pop up. Select right arrow to confirm receiver. If there is a failure, repeat steps 1-3.

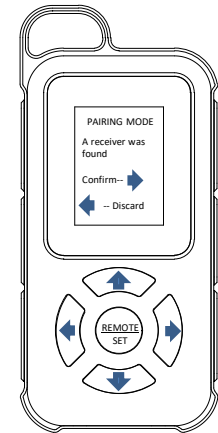

Step 5: Door Name Edit

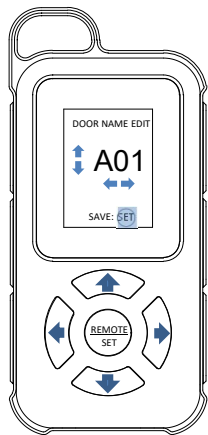

Once receiver has been confirmed, select door number. Select up or down arrow to select door letter and left or right arrow to select number. To save, press "Remote/Set" button.

Step 6: Door Pairing Complete

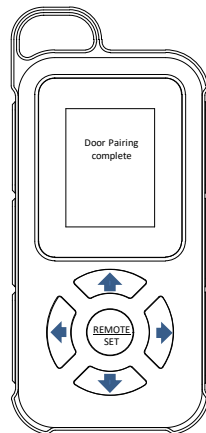

Step 7: Ready for use

Once pairing has been completed, press "Remote/Set" and cycle to paired door using left or right arrows. Once door is selected, press "Remote/Set" to open or close door.



Please note: Screen will turn off if inactive after 5 seconds.

Step 8: Ready for use

If the remote does not function as expected*; please refer to the manual for detailed info or call customer service: +1-800-294-4358