

# EURODRIVE & APEX PRO SMARTCONTROLLER™

Extreme® 1024 Door

This rolling door motor and advanced control system shipped with each door is specifically designed for reliability and longevity.

The advanced control system is a solid state, microprocessor-based control system. It represents the latest in rolling steel door drive technology and has been configured and set-up exclusively for each door. The APEX Pro SmartController is available across our full range of Extreme rolling products for streamlined and easy installation.



## SPECIFICATIONS

Drive System	UL listed, SEW Eurodrive, TEFC, NEMA 4X variable-speed motor and patented, high-performance brake prevents curtain from free falling in the unlikely event of operator component failure.	
Operation	Soft Stop and Soft Start	
Control	Advanced logic PCB control, with variable frequency drive and graphic LCD screen	
Voltage	120 V AC 1PH 60Hz* 208/230 V AC 1PH 60 Hz**	208/230 V AC 3PH 60Hz 460 V AC 3PH 60Hz
NEMA Rating	NEMA 4, 8.5" x 13" x 5.5" enclosure standard - Flexible conduit provided with "plug & play" electrical connectors for Motor and Control Panel interconnection	
Electrical Warranty	1,000,000 or 5 yrs	
Obstruction Detection	PNP type, NC photo eye and solid state relay type light curtain are standard; motion detectors and additional photo eyes are available as options. UL325 compliant light curtain. Sensor cable is color coded plug-and-play.	
24 V DC Outputs	A 24 V DC, 2A output is allotted for connection to the standard accessories. This output is available through several output terminals on the board, but the total current draw of all the devices connected should not exceed 2A.	
Auxiliary Outputs	The Auxiliary output contacts are not intended to be used to route power supply voltages to other components. They are rated as switching contacts for control voltages only. Total current should not exceed 200mA. The high power output module can do 125 V AC/3A limit relay output for 30 V DC/3A.	

\* Single phase available up to 2HP.

\*\* 120 V AC available for 1HP only.

MOTOR OPERATOR **EURODRIVE & APEX PRO SMARTCONTROLLER™**  
Extreme® 1024 Door

**EXTREME® 1024 DOOR OPERATOR**

MOTOR DIMENSIONS (In)*									
HP	Weight (lbs)	DIM A	DIM B	DIM C	DIM D	DIM E	DIM F	DIM G	DIM H
1	85	3.375	14.54	28.00	10.75	6.50	28.66	6.80	9.41
1.5	105	3.75	15.10	29.36	10.75	6.50	29.87	7.27	10.24
2	135	4.25	15.10	31.50	10.75	6.50	32.00	7.75	10.21
3	160	4.50	16.00	33.33	12.00	8.13	36.00	9.75	11.84
4	175	4.50	16.00	N/A	12.00	8.13	36.00	9.75	11.84
5	195	5.00	15.93	N/A	12.00	8.13	37.50	10.25	12.45

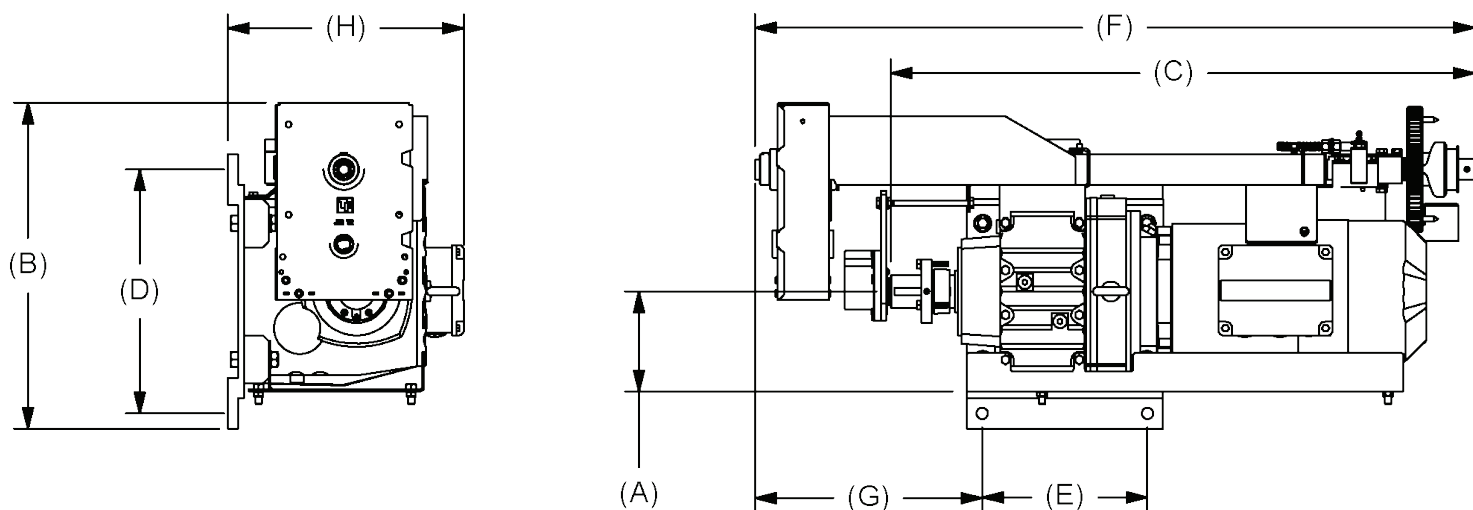

Volt	Phase	1 HP	1.5 HP	2 HP	3 HP	4 HP	5 HP
120**	1	14	-	-	-	-	-
230	1	7	10	11.5	-	-	-
230	3	4	5.6	6.4	9.6	12.8	16
460	3	2	2.8	3.2	4.8	6.4	8

\*7.5 HP will receive original APEX SmartController  
\*\*120 V AC step up transformer is used in conjunction with a 230 V AC, 1 PH Controller